

APPENDIX B

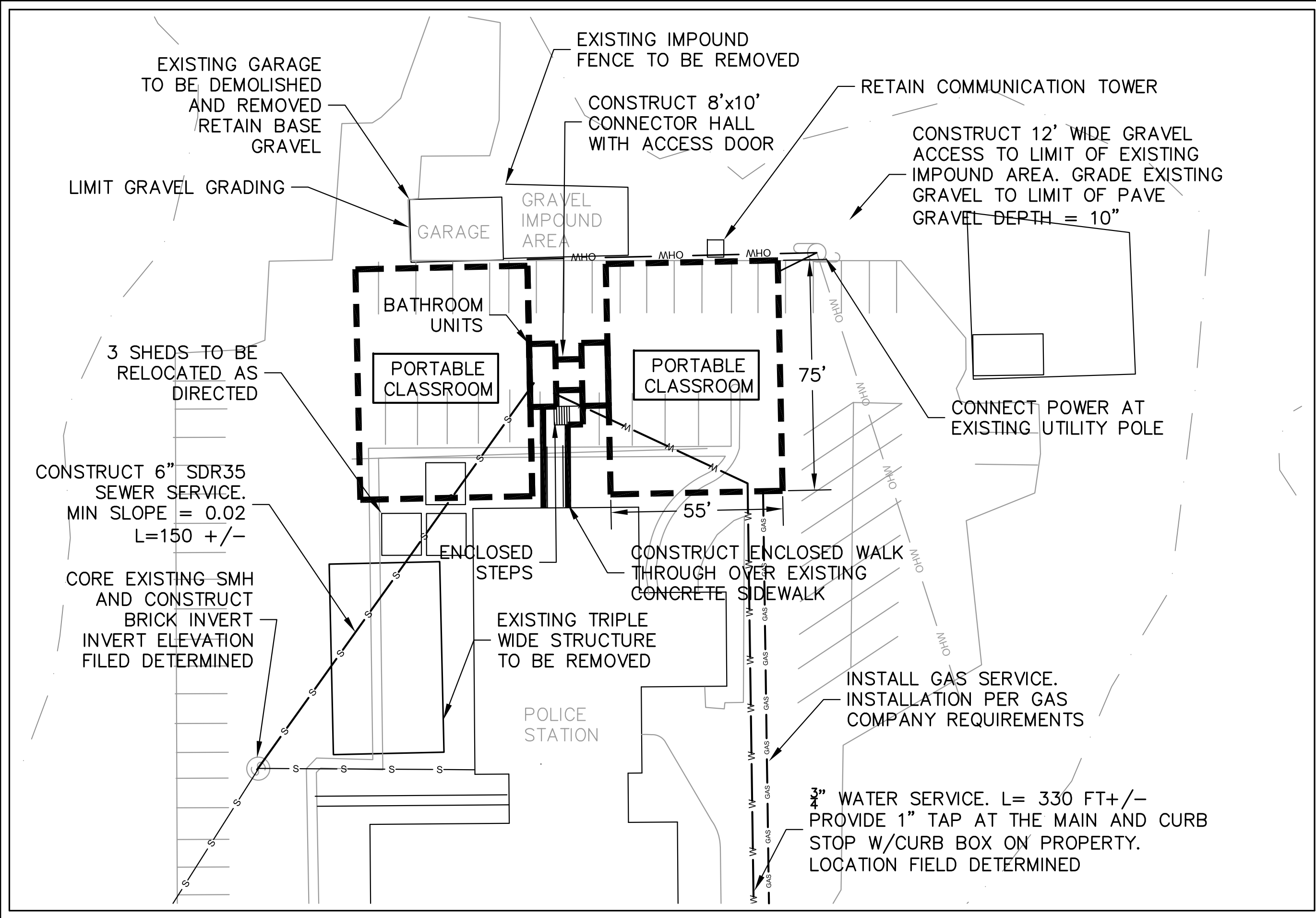

SALEM POLICE DEPARTMENT PORTABLE CLASSROOM RELOCATION		SITE PLAN	
TOWN OF SALEM 33 GEREMONTY DRIVE SALEM, NH 03079			
DATE:	01/18	JOB NO.	—
DWG.	C1	SCALE:	1"=30'